

## Transfer Oil Pump COMPONENTS

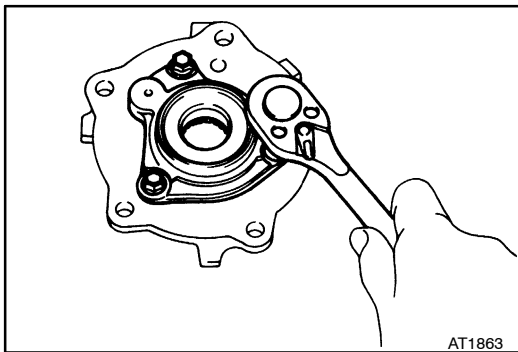
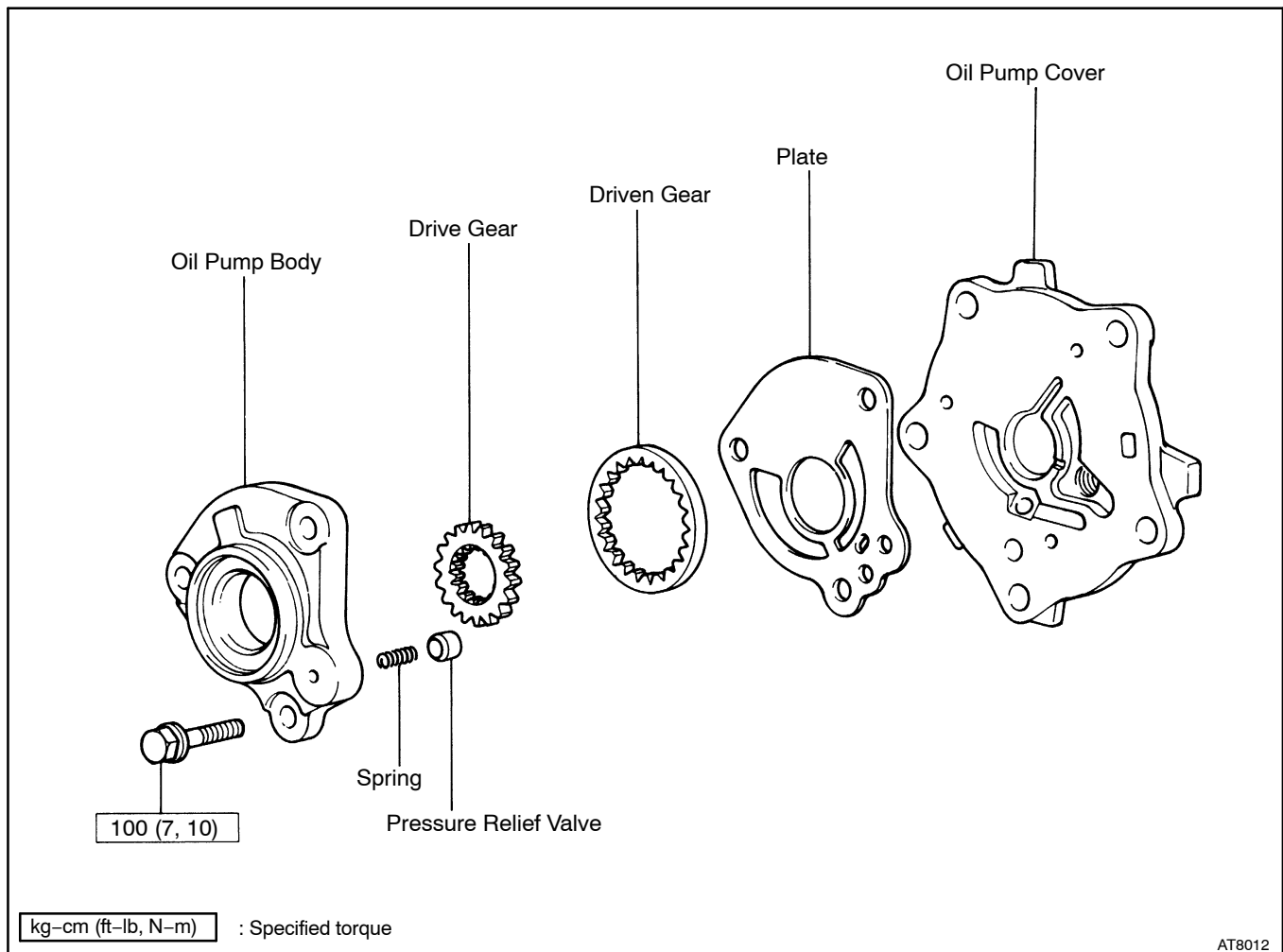

### DISASSEMBLY OF TRANSFER OIL PUMP

#### DISASSEMBLE TRANSFER OIL PUMP ASSEMBLY

- (a) Remove the three bolts, oil pump body and plate from the oil pump cover.

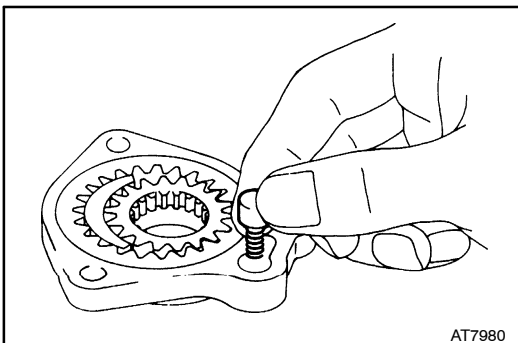

- (b) Remove the pressure relief valve and spring.

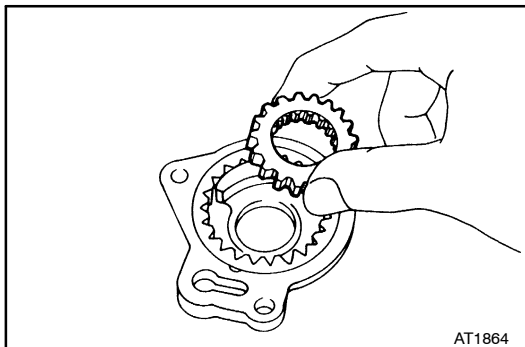

- (c) Remove the drive gear and driven gear.

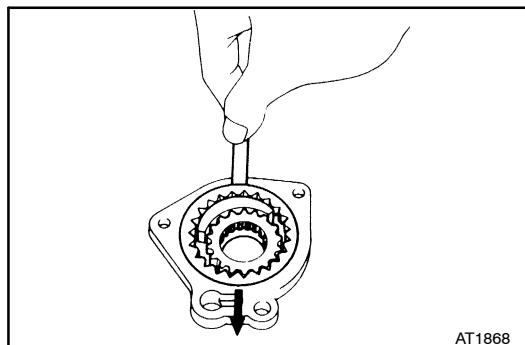

## INSPECTION OF TRANSFER OIL PUMP

### 1. CHECK BODY CLEARANCE OF DRIVEN GEAR

Push the driven gear to one side of the body. Using a feeler gauge, measure the clearance.

**Standard body clearance:** 0.07 – 0.15 mm  
(0.0028 – 0.0059 in.)

**Maximum body clearance:** 0.3 mm (0.012 in.)

If the body clearance is greater than the maximum, replace the drive gear, driven gear or pump body.

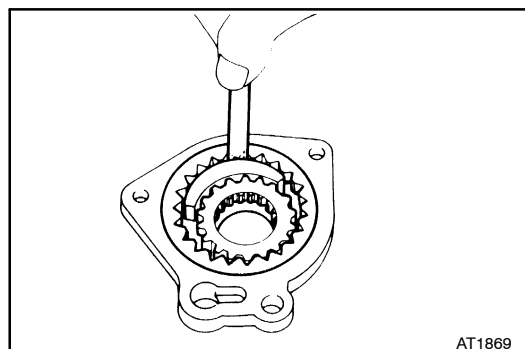

### 2. CHECK TIP CLEARANCE OF DRIVEN GEAR

Measure between the driven gear teeth and the crescent-shaped part of the pump body.

**Standard tip clearance:** 0.15 – 0.42 mm  
(0.0059 – 0.0165 in.)

**Maximum tip clearance:** 0.6 mm (0.024 in.)

If the tip clearance is greater than the maximum, replace the drive gear, driven gear or pump body.

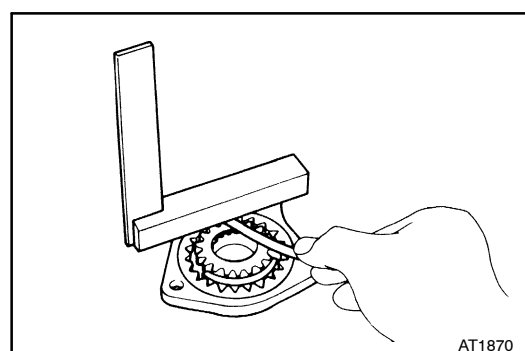

### 3. CHECK SIDE CLEARANCE OF BOTH GEARS

Using a steel straight edge and a feeler gauge, measure the side clearance of both gears.

**Standard side clearance:** 0.04 – 0.15 mm  
(0.0016 – 0.0059 in.)

**Maximum side clearance:** 0.3 mm (0.012 in.)

If the side clearance is greater than the maximum, replace the drive gear, driven gear or pump body.

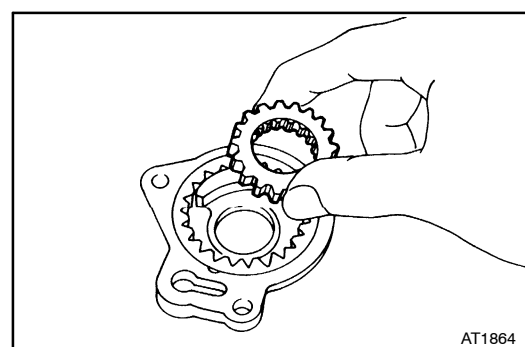

## ASSEMBLY OF TRANSFER OIL PUMP

### ASSEMBLE TRANSFER OIL PUMP ASSEMBLY

- (a) Coat the driven gear and drive gear with ATF.
- (b) Install the driven gear and drive gear.

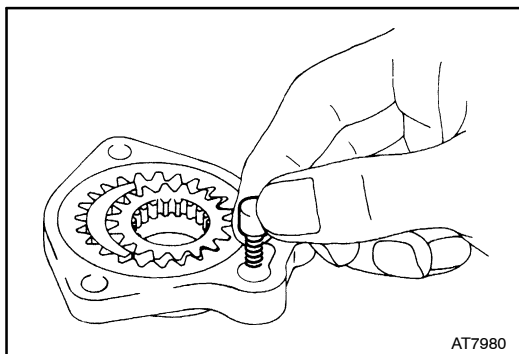

(c) Install the pressure relief valve and spring.

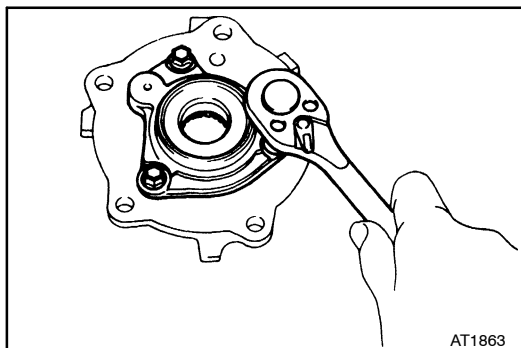

(d) Install the plate and oil pump body, and torque the three bolts.

**Torque: 100 kg-cm (7 ft-lb, 10 N-m)**